

7-20-1992

Weber Vineyards Spray Map

Unknown

Follow this and additional works at: https://digitalcommons.linfield.edu/owha_weber_docs



Part of the [Viticulture and Oenology Commons](#)

Recommended Citation

Unknown, "Weber Vineyards Spray Map" (1992). *Weber Vineyards Documents*. Document. Submission 2. https://digitalcommons.linfield.edu/owha_weber_docs/2

This Document is protected by copyright and/or related rights. It is brought to you for free via open access, courtesy of DigitalCommons@Linfield, with permission from the rights-holder(s). Your use of this Document must comply with the [Terms of Use](#) for material posted in DigitalCommons@Linfield, or with other stated terms (such as a Creative Commons license) indicated in the record and/or on the work itself. For more information, or if you have questions about permitted uses, please contact digitalcommons@linfield.edu.

7/20 -
JOSE

done by
ALW
7/21 Weber Vineyards

P.O. Box 148
Dundee, OR 97115
(503) 538-7260

LOTS 5/6 + 7 are
done.

LOTS ~~4~~ and ~~8~~ are left to do

If Polo hasn't completed 4 (leaf removal and
hedging)
work him + the crew to
the Chard (dos) and finish spraying 4.

There is 1/2 a
tank of mix
on the tractor
It should take
2 more tanks
to finish both
lots

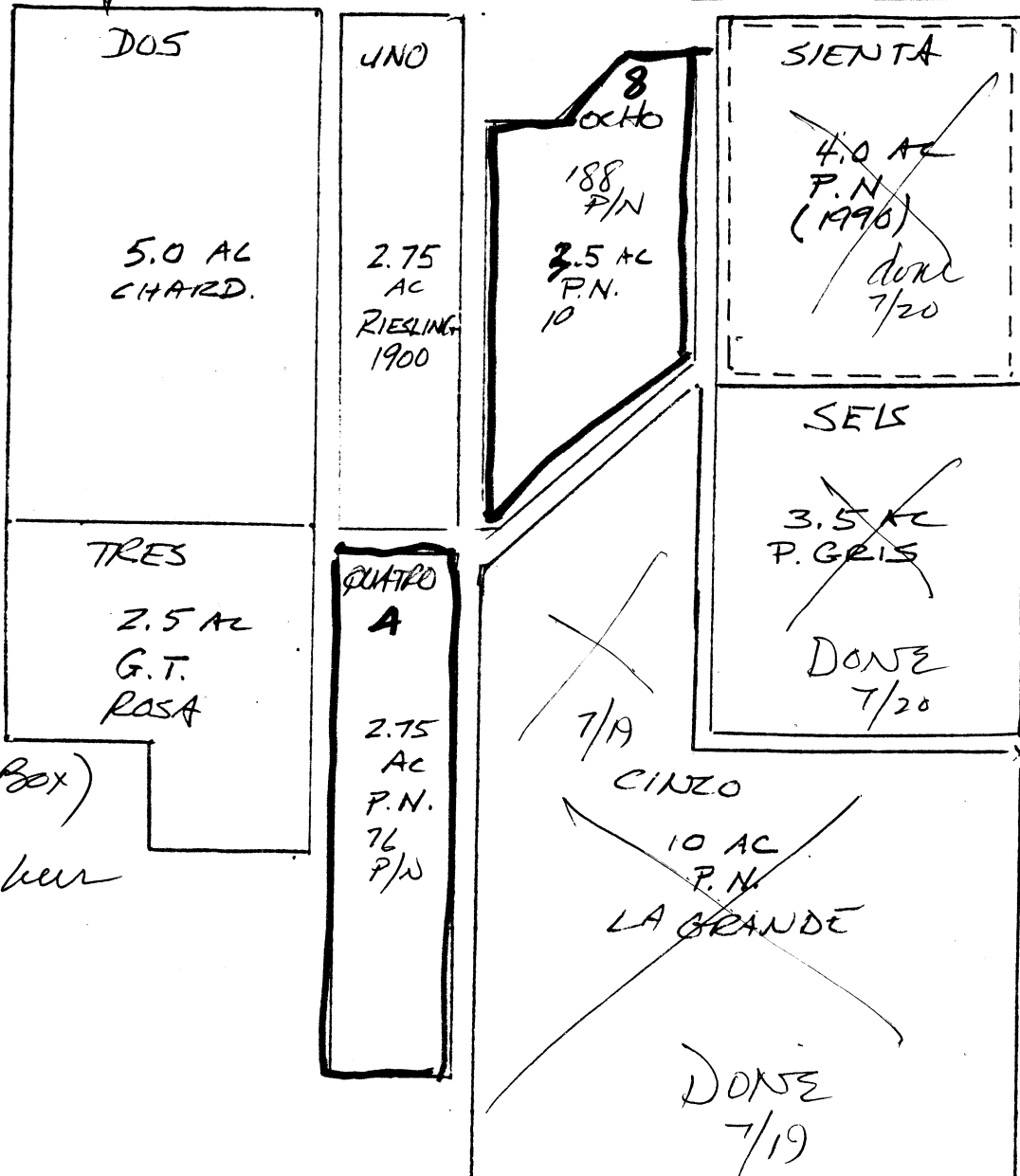

TANK MIX

- 1/2 container (1 1/4 gal Sulpher)
- 12 oz powdered Karathane (in Box) at tank
- 12 oz lime sulphur
- 24 oz mullin